



# DOOR COMPONENTS INC





## Building a Framework for Success

Door Components, Inc. was founded in 1981 by Bob Briggs Sr. to fill a void in the hollow metal industry. At the time, there were few custom manufacturers who could make special doors and frames on a very short lead time.

More than 30 years later, we have built our reputation as the service company that manufactures hollow metal doors and frames. Our expanded manufacturing plant is equipped with the most modern and advanced machinery available. With knowledgeable and experienced personnel continually striving for innovation and advancement, we are paving the way for the future of the hollow metal door industry.



## WHAT WE DO

At Door Components we manufacture custom and stock hollow metal doors and frames. Our philosophy is to provide you with the product you need when you need it. Period.

### TABLE OF CONTENTS

#### Metal Doors

Custom Honeycomb Core Doors	pg. 4
Custom Polystyrene Core Doors	pg. 4
Steel Stiffened Core Doors	pg. 5
Temperature Rise Core Doors	pg. 5
Lead Lined (radiation shielding) Doors	pg. 6
Rail and Stile Doors	pg. 6
Sound Transmission Control (STC) Doors	pg. 7
Bullet Resistant Doors	pg. 7

#### Metal Doors

Tornado Door	pg. 8
Integral Louver	pg. 8
Stainless Steel	pg. 8
Fire Rated	pg. 9
Integral Lite	pg. 9

#### Metal Door Systems

Dutch Doors	pg. 10
Double Egress	pg. 10

#### Frame Profiles

pg. 11

#### Frame Options

Hospital Stop	pg. 12
Bullet Resistant	pg. 13
Lead Lined	pg. 13
Side Lite	pg. 13
Fire Rated	pg. 13

#### Frames

KD Drywall	pg. 14
Double Egress	pg. 14
Pocket Slides	pg. 15
Masonry	pg. 15
Stainless Steel	pg. 16
Sound Transmission Control (STC)	pg. 16
Window	pg. 17

#### StockPlus™

pg. 18

#### Resources

pg. 19

### INDUSTRY AFFILIATIONS



# WHAT SETS US APART

Door Components is proud to be a manufacturer of custom hollow metal doors and frames on some of the most prestigious building projects in the Western United States and overseas. Our on-time delivery supports the growing demand for fast track construction; Door Components is staffed to meet our schedule commitments.

As a member of SDI (Steel Door Institute), our quality assurance meets or exceeds that required by SDI 100, ANSI A250 8 and HMMA 860/861 (NAAMM). Our fire rated products are tested and listed in strict compliance with provisions of NFPA 80, NFPA 252, ASTM E2074, UBC 7-2-1997 and UL 10B & 10C.



COMMERCIAL



CORPORATE



EDUCATION



HOSPITALITY



RELIGIOUS



MEDICAL



GOVERNMENT

## LEED AND SUSTAINABILITY

The benchmark for sustainable design in the United States is the Leadership in Energy and Environmental Design (LEED®) rating system developed by the U.S. Green Building Council (USGBC). Through this system, buildings become LEED certified by earning credits from the following categories: sustainable sites, water efficiency, energy and atmosphere, materials and resources, and indoor environmental quality.

Based on calculations of the American Iron and Steel Institute:

Door Components hollow metal products have a  
Steel Recycled Content Value = 37.1%

LEED credits applicable to the hollow metal products of Door Components are as follows:

### Materials & Resources LEED NC v3 Credit 4: Recycled Content

- Credit 4.1 (1 point)
- Credit 4.2 (1 point in addition to MR 4.1)

### Materials & Resources LEED NC v3 Credit 5: Regional Materials

- Credit 5.1 (1 point)
- Credit 5.2 (1 point in addition to MR 5.1)

Let us help as you strive to design green buildings that are safe, sustainable and aesthetically pleasing.

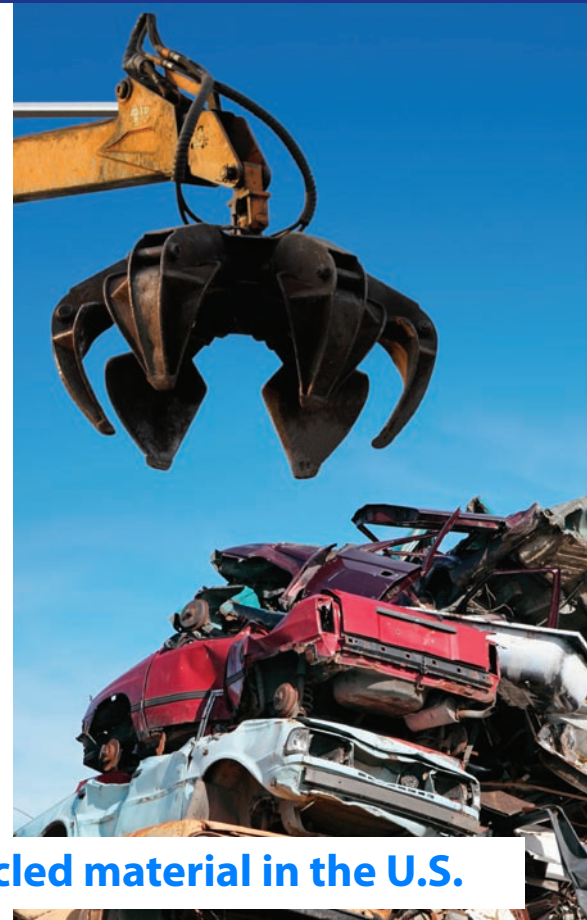

**Steel is the most recycled material in the U.S.**

## CUSTOM HONEYCOMB CORE DOORS



### FEATURES

- 1 3/4" standard; also available in 1 3/8"
- Any manufacturer's hinge locations
- 18-gauge A60 galvanized steel standard
- Continuously welded vertical edges (seamless) standard
- Rust inhibitive prime coat ANSI/SDI 250.10
- Also available as a stock door

### MATERIAL OPTIONS

- 16-gauge, 14-gauge and 12-gauge steel
- G90 galvanized steel
- Stainless steel
- Resin impregnated honeycomb

### FEATURE OPTIONS

- Up to 3 hour fire label
- Integral lite option
- Integral louver option
- Flush top cap
- Any manufacturer's Deadlock prep, Panic prep, and Mortise sectional trim
- Flat bar astragal (pairs)

### HARDWARE REINFORCEMENTS

- 3/16" for hinges
- 12-gauge for locks – standard
- 14-gauge for closers – standard
- Heavier gauge reinforcements available

Also available as a Stock Door. See StockPlus™ on page 18 of this catalog.



**10 MILLION CYCLES** | Successfully completed in independent test

## CUSTOM POLYSTYRENE CORE DOORS



### FEATURES

- 1 3/4" standard; also available in 1 3/8"
- Any manufacturer's hinge locations
- 18-gauge A60 galvanized steel standard
- Continuously welded vertical edges (seamless) standard
- Rust inhibitive prime coat ANSI/SDI 250.10
- Also available as a stock door

### MATERIAL OPTIONS

- 16-gauge, 14-gauge and 12-gauge steel
- G90 galvanized steel
- Stainless steel

### FEATURE OPTIONS

- Up to 3 hour fire label
- Integral lite option
- Integral louver option
- Flush top cap
- Any manufacturer's Deadlock prep, Panic prep, and Mortise sectional trim
- Flat bar astragal (pairs)

### HARDWARE REINFORCEMENTS

- 3/16" for hinges
- 12-gauge for locks standard
- 14-gauge for closers standard
- Heavier gauge reinforcements available

Also available as a Stock Door. See StockPlus™ on page 18 of this catalog.



**2 MILLION CYCLES** | Successfully completed in independent test

## STEEL STIFFENED DOORS

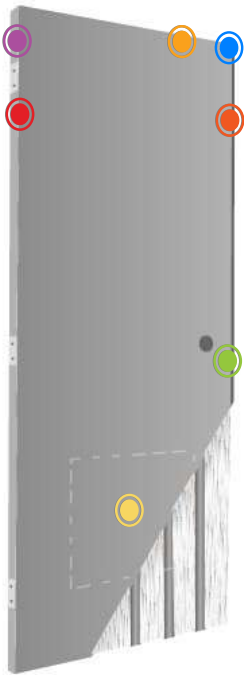

### FEATURES

- 1 3/4" standard; other thicknesses available
- Any manufacturer's hinge locations
- 18-gauge steel A60 galvanized standard
- 20-gauge stiffeners spot-welded at 6" on center with fiberglass insulation
- Continuously welded vertical edges (seamless) standard
- Rust inhibitive prime coat ANSI/SDI 250.10

### MATERIAL OPTIONS

- 16-gauge, 14-gauge, 12-gauge, and 10-gauge steel
- G90 galvanized steel
- Stainless steel, available in 304 or 316 alloys
- 18-gauge stiffeners spot-welded

### FEATURE OPTIONS

- Up to 3 hour fire label
- Integral lite option
- Integral louver option
- Flush top cap
- Any manufacturer's Deadlock prep, Panic prep, and Mortise sectional trim
- Flat bar astragal (pairs)

### HARDWARE REINFORCEMENTS

- 3/16" for hinges
- 12-gauge for locks standard
- 14-gauge for closers standard
- Heavier gauge reinforcements available



**4 MILLION CYCLES** | Successfully completed in independent test

## TEMPERATURE RISE DOORS



### FEATURES

- 1 3/4" standard
- Any manufacturer's hinge locations
- 18-gauge steel A60 galvanized standard
- 18-gauge top and bottom channels spot welded to face sheets
- Continuously welded vertical edges (seamless) standard (open seam available)
- 60 – 180 min. labels available for 450°, and 250° temp rise at 30 min.
- Rust inhibitive prime coat ANSI/SDI 250.10

### MATERIAL OPTIONS

- 16-gauge and 14-gauge steel
- G90 galvanized steel

### FEATURE OPTIONS

- Integral lite option, up to 100 sq. inches (only for 60 and 90 min. ratings)
- Flush top cap
- Any manufacturer's Deadlock prep, Panic prep, and Mortise sectional trim
- Flat bar astragal (pairs)

### HARDWARE REINFORCEMENTS

- 3/16" for hinges
- 12-gauge for locks standard
- 14-gauge for closers standard
- Heavier gauge reinforcements available

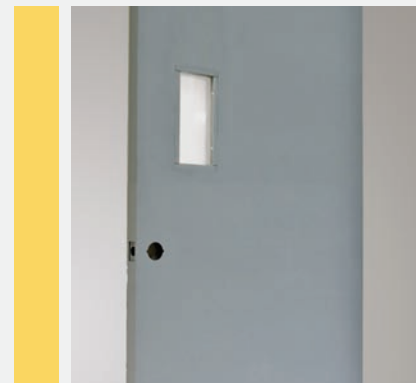

## LEAD LINED (RADIATION SHIELDING) DOORS



### FEATURES

- 1 3/4" standard; other thicknesses available
- Medical shielding uses
- Any manufacturer's hinge locations
- 18-gauge galvanized steel standard
- 18-gauge top and bottom channels spot welded to face sheets
- Continuously welded vertical edges (seamless) standard
- Rust inhibitive prime coat ANSI/SDI A250.10
- 99.9% pure lead meeting federal specifications QQ-L-201F Grade C and ASTM B749

### MATERIAL OPTIONS

- 16-gauge and 14-gauge steel
- Stainless steel, available in 304 or 316 alloys
- Door Components does not sell lead glass. Glass is procured and installed by others.

### FEATURE OPTIONS

- Flush top cap
- Any manufacturer's Deadlock prep, Panic prep, and Mortise sectional trim

### HARDWARE REINFORCEMENTS

- 3/16" for hinges
- 12-gauge for locks standard
- 14-gauge for closers standard
- Heavier gauge reinforcements available



## RAIL AND STILE DOORS



### FEATURES

- Vision lite standard
- Any manufacturer's hinge locations
- 1 3/4" standard
- 18-gauge top and bottom inverted channels spot welded to face sheets
- Continuously welded vertical edges (seamless) standard
- 18-gauge galvanized steel standard
- Rust inhibitive prime coat ANSI/SDI 250.10

### MATERIAL OPTIONS

- 16-gauge and 14-gauge steel
- G90 galvanized steel
- Stainless steel, available in 304 or 316 alloys

### FEATURE OPTIONS

- Up to 90 minute fire label
- Integral louver option
- Flush top cap
- Any manufacturer's Deadlock prep, Panic prep, and Mortise sectional trim
- Flat bar astragal (pairs)

### HARDWARE REINFORCEMENTS

- 3/16" for hinges
- 12-gauge for locks standard
- 14-gauge for closers standard
- Heavier gauge reinforcements available

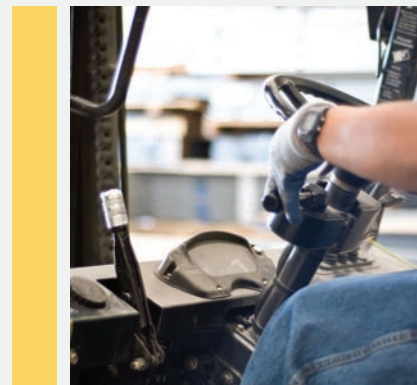

## SOUND TRANSMISSION CONTROL (STC) DOORS

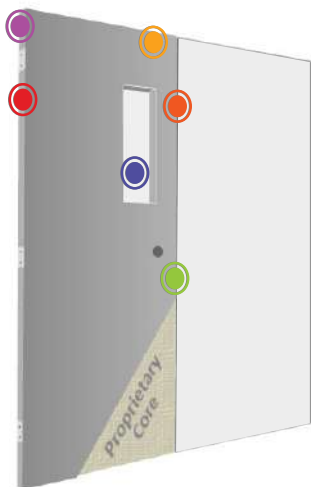

### FEATURES

- **NEW!** Up to and including STC 48 for pairs of doors; includes factory-supplied astragal
- STC core is Door Components patented design
- All STC ratings available for single doors up to and including STC 54
- 1 3/4" doors (light weight for STC doors)
- Any manufacturer's hinge locations
- Continuously welded vertical edges (seamless) standard
- Uses 4 1/2" .180 heavyweight hinge (not supplied)
- No cam lift hinge required
- All required seals and a threshold are included
- Galvannealed steel standard
- Single door vision lites available up to and including STC 48
- Rust inhibitive prime coat ANSI/SDI A250.10
- Tested in accordance with ASTM E90-09
- Frame must be grout filled (by others)
- STC frames available

### MATERIAL OPTIONS

- Stainless steel, available in 304 or 316 alloys

### FEATURE OPTIONS

- Up to 90 minute fire label
- Integral lite option
- Flush top cap
- Any manufacturer's Deadlock prep, Panic prep, and Mortise sectional trim
- Astragal ( for pairs)

### HARDWARE REINFORCEMENTS

- 3/16" for hinges
- 12-gauge for locks standard
- 14-gauge for closers standard
- Heavier gauge reinforcements available

### STC Transmission Class Capabilities

STC Range	Description
STC 50 - STC 54	Very loud sounds are faintly heard
STC 40 - STC 49	Loud speech is barely audible
STC 35 - STC 39	Loud speech is audible but words hard to distinguish
STC 30 - STC 34	Loud speech can be distinguished; normal speech barely heard or inaudible

## BULLET RESISTANT DOORS



### FEATURES

- Tested in accordance with UL 752 level 1 through 8 for ballistic products
- 1 3/4" standard
- Any manufacturer's hinge locations
- 16-gauge A60 galvannealed steel standard
- Minimum 16-gauge steel faces
- Continuously welded vertical edges (seamless) standard
- Rust inhibitive prime coat ANSI/SDI 250.10
- Bullet resistant frames available

### MATERIAL OPTIONS

- 16-gauge steels
- G90 galvanized steel
- Stainless steel, available in 304 or 316 alloys

### FEATURE OPTIONS

- Vision lite frame
- Flush top cap
- Any manufacturer's Deadlock prep, Panic prep, and Mortise sectional trim

### HARDWARE REINFORCEMENTS

- 3/16" for hinges
- 12-gauge for locks standard
- 14-gauge for closers standard
- Heavier gauge reinforcements available

### Threat Level

LEVEL	CALIBER	BULLET	SHOTS
1	9mm (124g) FMJ		3
2	.357 Magnum (158g) SP		3
3	.44 Magnum (244g) SP		3
4	.30 Caliber Rifle (180g) SP		1
5	7.62mm Rifle (150g) FMJ		1
6	9mm Multi (124g) FMJ		5
7	5.56mm Rifle (55g)		5
8	7.62 Multi Rifle (150g) FMJ		5
8 (AP)	30-60 Rifle (166g) AP		5

# METAL DOORS

## TORNADO RESISTANT - FEMA 361 | ICC-500 Compliant

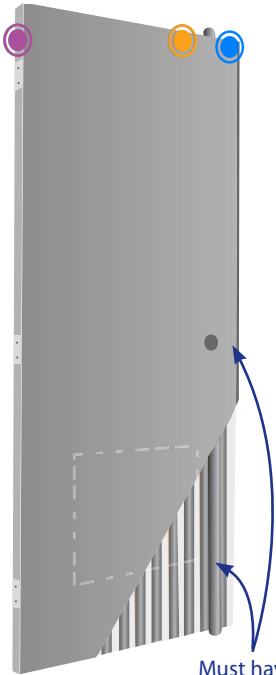

### FEATURES

- 1 3/4" standard thickness
- Any manufacturer's butt hinge
- 14-gauge steel A60 galvanized standard
- 12-gauge stiffeners spot-welded at 4" on center with fiberglass insulation
- Continuously welded vertical edges (seamless) standard
- Rust inhibitive prime coat ANSI/SDI 250.10
- Available up to 4'x8' singles/8'x8' pairs
- Singles available in-swing or out-swing

### MATERIAL OPTIONS

- G90 galvanized steel

### FEATURE OPTIONS

- Flush top cap
- Must use with Securitech hardware

Must have multi-point latching by Securitech (not provided by Door Components). May be surface or concealed in door.

## INTEGRAL LOUVER



### FEATURES

- Door with louvers installed as a completed unit

### DOOR OPTIONS

- Honeycomb core doors (custom)
- Polystyrene core doors (custom)
- Dutch doors
- Rail and stile doors

### FEATURE OPTIONS

- Optional insect screen

## STAINLESS STEEL



### FEATURES

- Any manufacturer's hinge locations
- 18-gauge top and bottom channels
- Continuously welded vertical edges (seamless) standard
- 1 3/4" standard
- 18-gauge stainless steel standard
- 304 alloy with #4 finish standard

### MATERIAL OPTIONS

- 316 alloy with #4 or #8 finish
- 16-gauge, 14-gauge steel
- #2b finish

### FEATURE OPTIONS

- Up to 90 minute fire label
- Integral lite option
- Integral louver option
- Flush top cap
- Any manufacturer's Deadlock prep, Panic prep, and Mortise sectional trim
- Flat bar astragal (pairs)

### HARDWARE REINFORCEMENTS

- All internal components are stainless steel
- 3/16" for hinges
- 12-gauge for locks standard
- 14-gauge for closers standard

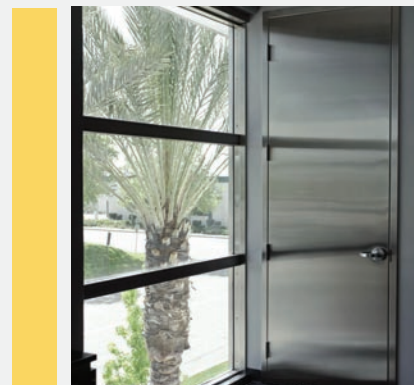



## FIRE RATED



### FEATURES

- Up to 3 hour fire label
- Includes some doors with lites
- Wire glass, Pilkington Glass w/ Pemko fireglaze (or equal) and Firelite (or equal) glass, supplied by others
- Fire rated frames available

### DOOR OPTIONS FOR FIRE RATING

- Honeycomb core doors – custom and stock
- Polystyrene core doors – custom and stock
- Dutch doors
- Rail and stile doors
- Sound Transmission Control (STC)
- Stainless steel doors
- Steel stiffened core doors
- Temperature rise core doors

### HARDWARE REINFORCEMENTS

- Integral lite
- Flush top cap
- Flat bar astragal (pairs) optional



## INTEGRAL LITE



### FEATURES

- Vision lite cutout and frame without factory-supplied glass is standard
- Door with glass installed as a completed unit (option)
- Most common glass types and sizes in stock for rapid installation

### FEATURE OPTIONS

- Honeycomb core doors (custom)
- Polystyrene core doors (custom)
- Dutch doors
- Rail and stile doors
- Stainless steel doors
- Steel stiffened core doors
- Temperature rise core doors

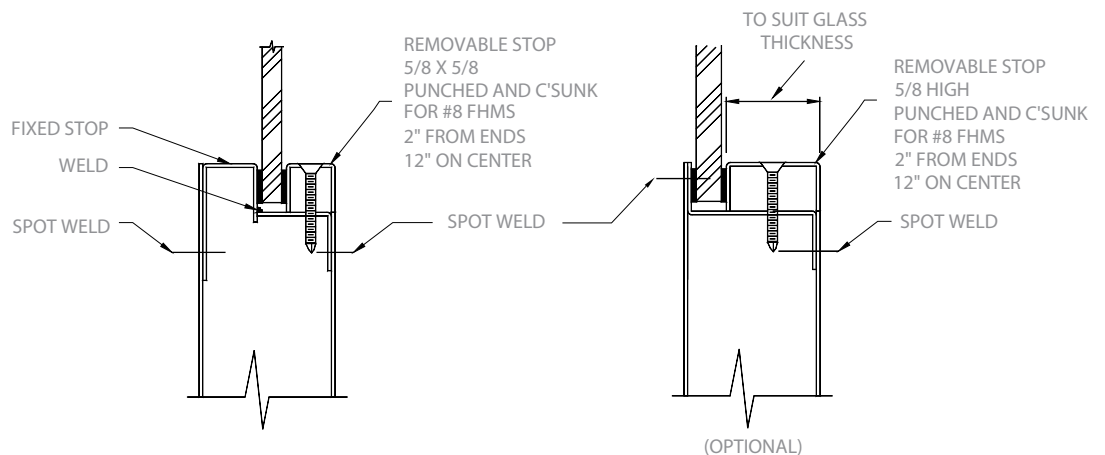

- 1) 16 GA GLASS STOP (OTHER GAUGES AVAILABLE)
- 2) REMOVABLE STOP IS PUNCHED AND COUNTERSUNK 2" FROM ENDS AND 12" ON CENTER (MIN 2 PER SIDE)

## DUTCH DOORS



### FEATURES

- 1 3/4" standard; other thicknesses available
- Any manufacturer's hinge locations
- 18-gauge A60 galvanized steel standard
- Continuously welded vertical edges (seamless) standard
- Rust inhibitive prime coat ANSI/SDI 250.10
- Honeycomb core standard

### MATERIAL OPTIONS

- 16-gauge, 14-gauge and 12-gauge steel
- G90 galvanized steel
- Stainless steel, available in 304 or 316 alloys
- Polystyrene core

### FEATURE OPTIONS

- Single and double-sided shelf
- Up to 3 hour fire label
- Integral lite option
- Flush top cap
- Any manufacturer's Deadlock prep, Panic prep, and Mortise sectional trim
- Flat bar astragal

### HARDWARE REINFORCEMENTS

- 3/16" for hinges
- 12-gauge for locks standard
- 14-gauge for closers standard
- Heavier gauge reinforcements available

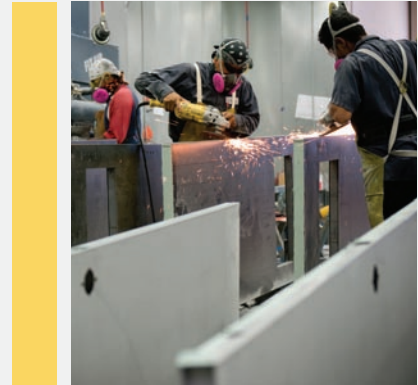

## DOUBLE EGRESS DOORS

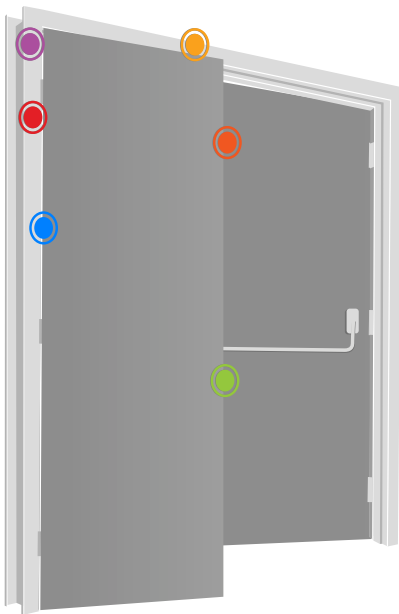

### FEATURES

- 1 3/4" standard
- Any manufacturer's hinge locations
- 18-gauge A60 galvanized steel standard
- Continuously welded vertical edges (seamless) standard
- Rust inhibitive prime coat ANSI/SDI 250.10

### MATERIAL OPTIONS

- 16-gauge, 14-gauge and 12-gauge steel
- G90 galvanized steel
- Stainless steel available in 304 or 316 alloys
- Resin impregnated honeycomb

### FEATURE OPTIONS

- Up to 3 hour fire label
- Flush top cap
- Any manufacturer's Deadlock prep, Panic prep, and Mortise sectional trim
- Flat bar astragal (pairs)

### HARDWARE REINFORCEMENTS

- 3/16" for hinges
- 12-gauge for locks standard
- 14-gauge for closers standard
- Heavier gauge reinforcements available

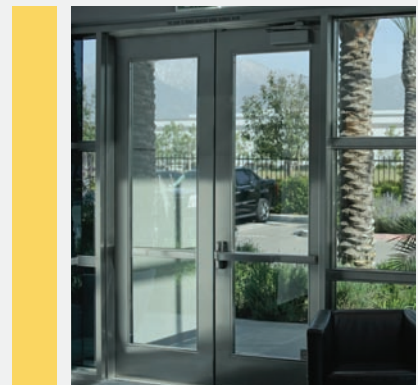

## CUSTOM DOOR FRAME PROFILES

All frames are custom manufactured to your order. Here are some examples of frames that we can build.

Available in 12-gauge, 14-gauge, and 16-gauge A60 Hot Dipped Galvanized Steel ASTM A653.

Face profile may be combined with any backbend. Backbends can be any combination on the same frame to meet your needs.

G90 Galvanized Steel available.

Stainless Steel available (#4 finish).

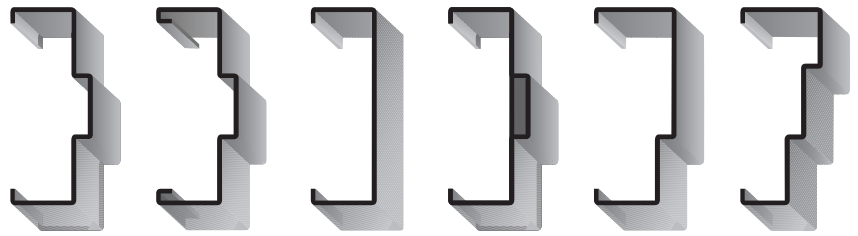

F1

F3

F9

F16

F2

F15

## WALL ANCHORS

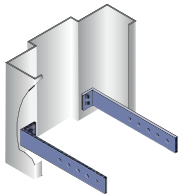

A1  
Standard Strap  
Anchor

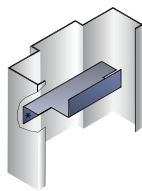

A2  
Flush Metal Stud  
Anchor

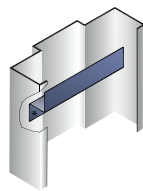

A3  
Recessed Metal  
Stud Anchor

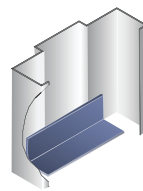

A4  
Standard Base  
Anchor

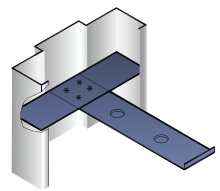

A5  
Masonry Steel  
Anchor

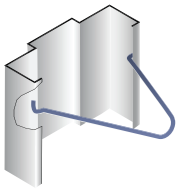

A6  
Alternate Masonry  
Steel Anchor

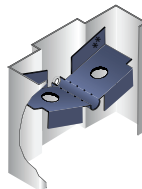

A7B  
Punch & Dimple  
"Butterfly" Anchor

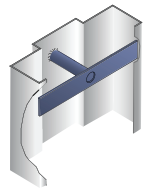

A7P  
Punch & Dimple  
Alternate Masonry Anchor

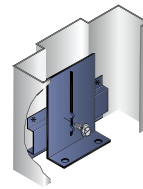

A8  
Adjustable Base  
Anchor 5/32

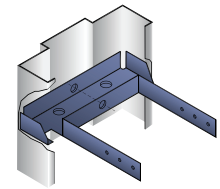

A9  
Twist In Universal  
Anchor

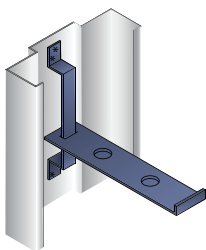

A11  
Adjustable Masonry  
Anchor

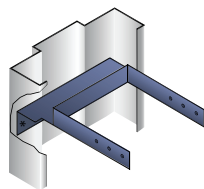

A9W  
Welded In Universal  
Anchor

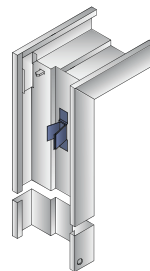

A10  
KDDW Compressed  
Anchor

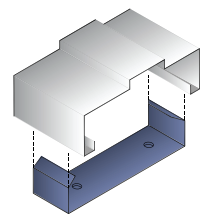

A12  
Floor Anchor

# FRAME OPTIONS

Door Components is a hollow metal door and frame manufacturer specializing in the rapid shipment of custom products. All of our doors and frames are manufactured to our clients' specifications.

While our specialty is manufacturing custom frames, we also make stock KD drywall and masonry frames to your specifications.

Our standard frame product is 16-gauge galvanized steel; we offer other material options including G90 galvanized and stainless steel. See the individual frame pages for details.

As a member of the Steel Door Institute, you can be assured that all Door Components products meet the highest standards in the hollow metal industry.

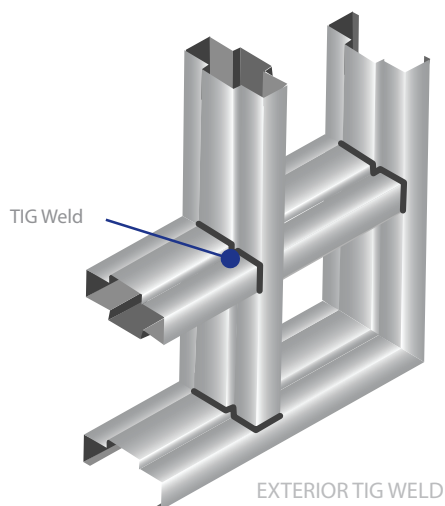
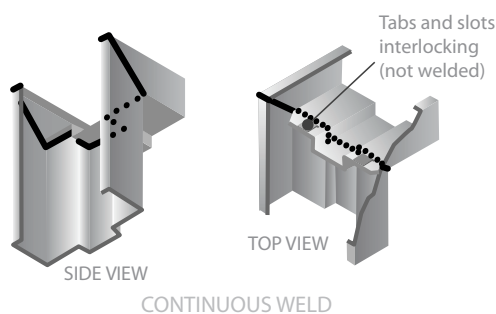
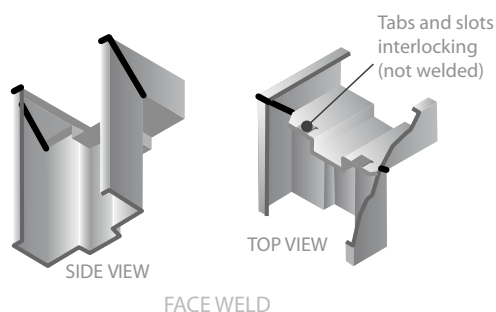

Take advantage of the full Door Components treatment. Let us provide that finishing touch to your project with our custom products:

- Face welds
- Continuous welds (additional charge)
- TIG welds (additional charge)
- Quality welding by factory-trained technicians
- Professional grinding and baked-on primer paint finish
- No mismatched or missing components
- No jobsite sorting of stick components
- No additional time loss; same delivery time welded or KD
- Picked up at our dock or delivered to your shop or job, ready to install
- Strict adherence to welding standards; OSHPOD-quality welds.
- No need for certified welder at jobsite
- No certified payroll requirement, for a factory-complete product

## Hospital Stop

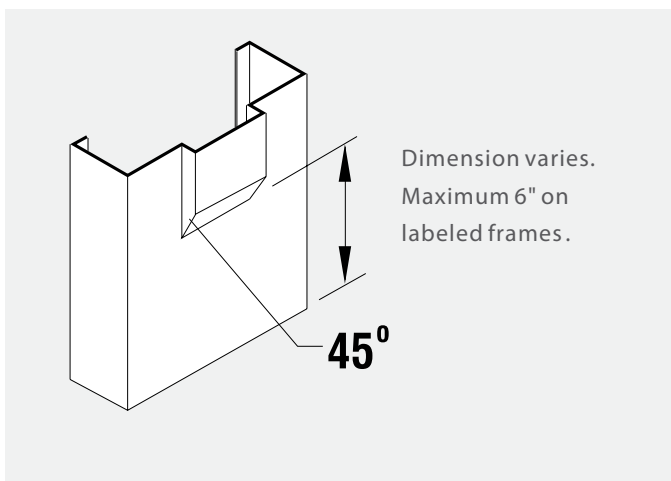

## LEAD LINED (RADIATION SHIELD)

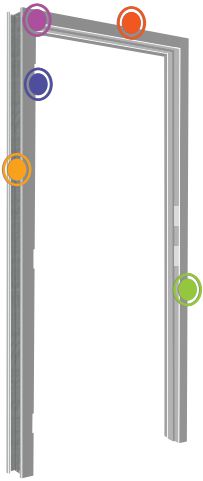

### FEATURES

- Radiation shielding capabilities
- Medical shielding uses
- Face weld
- 16-gauge A60 galvanized steel standard
- 7-gauge hinge reinforcements standard
- 12-gauge closer reinforcements standard
- Rust-inhibitive prime coat ANSI/SDI 250.10
- Any manufacturer's hinge locations
- Any manufacturer's strike prep location
- Anchors to meet any wall construction
- Any width and height
- Any jamb depth
- Lead Lined doors available
- 99.9% pure lead meeting federal specifications QQ-L-201F, Grade C and ASTM B749

### MATERIAL OPTIONS

- 14-gauge and 12-gauge steel
- Available in Stainless Steel

### FEATURE OPTIONS

- Continuous weld

### HARDWARE REINFORCEMENTS

- Optional prep to accept all manufacturers' hardware requirements

## BULLET RESISTANT

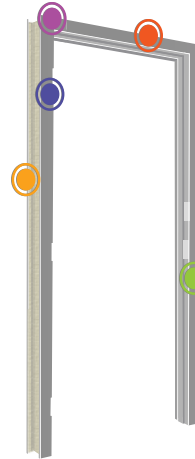

### FEATURES

- Tested in accordance with UL 752 level 1 through 8 for ballistic products
- Face weld
- 16-gauge A60 galvanized steel standard
- 7-gauge hinge reinforcements standard
- 12-gauge closer reinforcements standard
- Rust-inhibitive prime coat ANSI/SDI 250.10
- Any manufacturer's hinge locations
- Any manufacturer's strike prep location
- Anchors to meet any wall construction
- Any width and height
- Any jamb depth
- Bullet resistant doors available

### MATERIAL OPTIONS

- 14-gauge and 12-gauge steel
- Available in Stainless Steel

### FEATURE OPTIONS

- Continuous weld

### HARDWARE REINFORCEMENTS

- Optional prep to accept all manufacturers' hardware requirements

## SIDE LITE

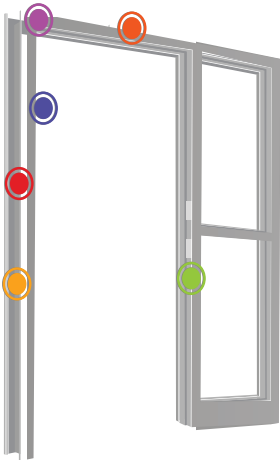

### FEATURES

- Face weld
- 16-gauge A60 galvanized steel standard
- 7-gauge hinge reinforcements standard
- 12-gauge closer reinforcements standard
- Rust-inhibitive prime coat ANSI/SDI 250.10
- Any manufacturer's hinge locations
- Any manufacturer's strike prep location
- Anchors to meet any wall construction
- Any width and height
- Any jamb depth
- Glass stop 3/8" width standard - custom sizes available
- Glazing not included

### MATERIAL OPTIONS

- 14-gauge and 12-gauge steel
- Available in Stainless Steel

### FEATURE OPTIONS

- Up to 90 minute fire label

### HARDWARE REINFORCEMENTS

- Optional prep to accept all manufacturers' hardware requirements

## FIRE RATED

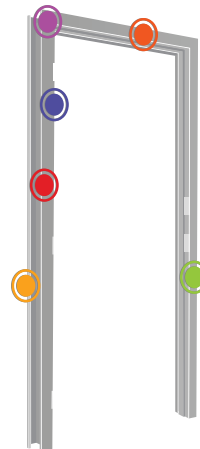

### FEATURES

- Face weld
- 16-gauge A60 galvanized steel standard
- 7-gauge hinge reinforcements standard
- 12-gauge closer reinforcements standard
- Rust-inhibitive prime coat ANSI/SDI 250.10
- Any manufacturer's hinge locations
- Any manufacturer's strike prep location
- Anchors to meet any wall construction
- Any width and height
- Any jamb depth

### MATERIAL OPTIONS

- 14-gauge and 12-gauge steel
- Available in Stainless Steel

### FEATURE OPTIONS

- Deadlock strike
- Continuous weld
- Up to 3 hour fire label

### HARDWARE REINFORCEMENTS

- Optional prep to accept all manufacturers' hardware requirements

## KD DRYWALL FRAMES

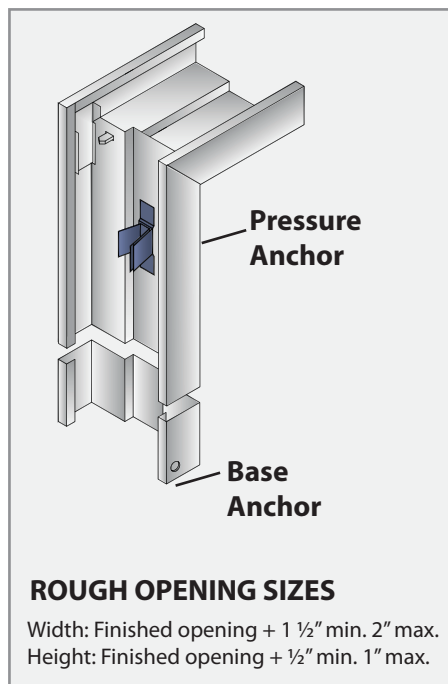
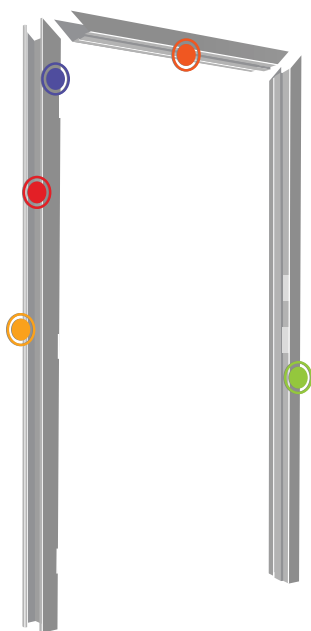

### FEATURES

- 16-gauge A60 galvanized steel standard
- 7-gauge hinge reinforcements standard
- 12-gauge closer reinforcements standard
- Rust-inhibitive prime coat ANSI/SDI 250.10
- ● Any manufacturer's hinge locations
- ● Any manufacturer's strike prep location
- ● KD Drywall Anchor
- Any width and height
- Any jamb depth

### MATERIAL OPTIONS

- 14-gauge steel
- Available in Stainless Steel

### FEATURE OPTIONS

- ● Up to 90 minute fire label
- Hospital stop

### HARDWARE REINFORCEMENTS

- ● Optional prep to accept all manufacturers' hardware requirements

Also available as a Stock Frame. See StockPlus™ on page 18 of this catalog.

## DOUBLE EGRESS FRAMES

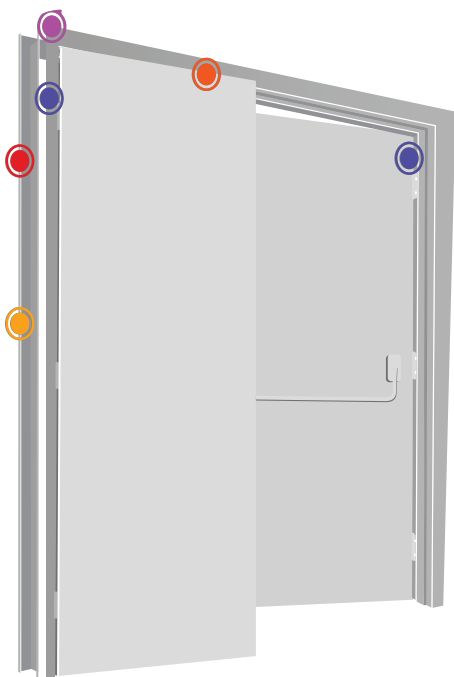

### FEATURES

- ● Face weld
- 16-gauge A60 galvanized steel standard
- 7-gauge hinge reinforcements standard
- 12-gauge closer reinforcements standard
- Rust-inhibitive prime coat ANSI/SDI 250.10
- ● Any manufacturer's hinge locations
- ● Anchors to meet any wall construction
- Any width and height
- Any jamb depth
- Double egress doors available

### MATERIAL OPTIONS

- 14-gauge and 12-gauge steel
- Available in Stainless Steel

### FEATURE OPTIONS

- Continuous weld
- ● Up to 3 hour fire label

### HARDWARE REINFORCEMENTS

- ● Optional prep to accept all manufacturers' hardware requirements

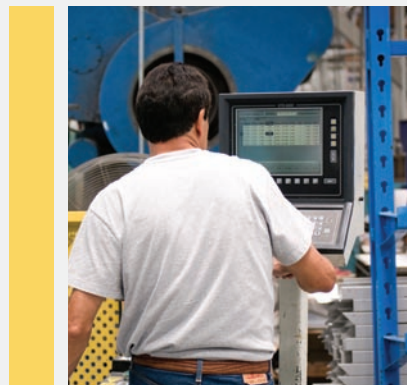

## POCKET SLIDER FRAME

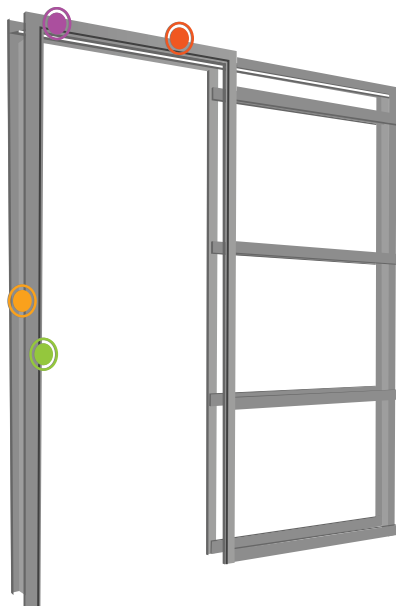

### FEATURES

- Face weld
- 16-gauge A60 galvanized steel standard
- Rust-inhibitive prime coat ANSI/SDI 250.10
- Any manufacturer's strike prep location
- Anchors to meet any wall construction
- Any width and height
- Any jamb depth

### MATERIAL OPTIONS

- 14-gauge and 12-gauge steel
- Available in Stainless Steel

### FEATURE OPTIONS

- Continuous weld

### HARDWARE REINFORCEMENTS

- Optional prep to accept all manufacturers' hardware requirements
- Sliding track and hardware not provided



## MASONRY FRAMES

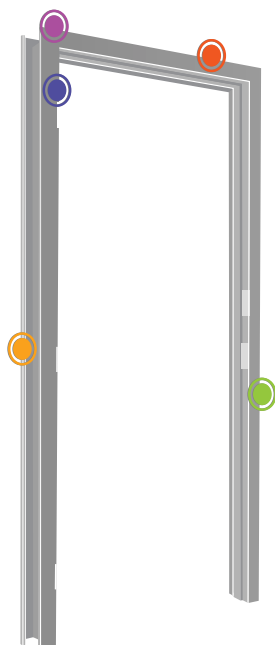

### FEATURES

- Face weld
- 16-gauge A60 galvanized steel standard
- 7-gauge hinge reinforcements standard
- 12-gauge closer reinforcements standard
- Rust-inhibitive prime coat ANSI/SDI 250.10
- Any manufacturer's hinge locations
- Any manufacturer's strike prep location
- Anchors to meet any wall construction
- Any width and height
- Any jamb depth

### MATERIAL OPTIONS

- 14-gauge and 12-gauge steel
- Available in Stainless Steel

### FEATURE OPTIONS

- Continuous weld

### HARDWARE REINFORCEMENTS

- Optional prep to accept all manufacturers' hardware requirements

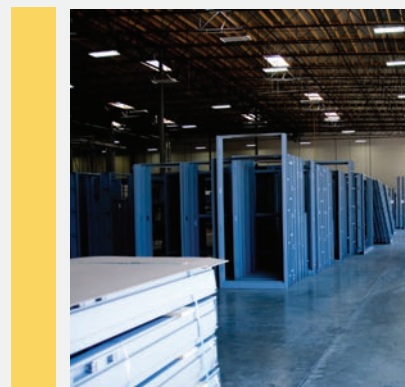

Also available as a Stock Frame. See StockPlus™ on page 18 of this catalog.

## STAINLESS STEEL FRAMES

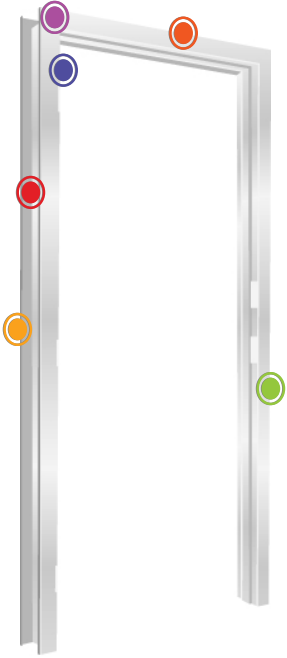

### FEATURES

- Face weld
- 16-gauge stainless steel with #4 finish is standard
- 304 alloy
- 7-gauge stainless steel hinge reinforcements standard
- 12-gauge closer reinforcements standard
- Any manufacturer's hinge locations
- Any manufacturer's strike prep location
- Stainless Steel Anchors to meet any wall construction
- Stainless steel lock reinforcements per SDI 250.8 Table 4
- Any width and height
- Any jamb depth
- Stainless steel doors available

### MATERIAL OPTIONS

- 316 alloy with #4 or #8 finish
- 14-gauge stainless steel
- #2b finish

### FEATURE OPTIONS

- Continuous weld
- Up to 3 hour fire label

### HARDWARE REINFORCEMENTS

- Optional prep to accept all manufacturers' hardware requirements



## SOUND TRANSMISSION CONTROL (STC) FRAMES

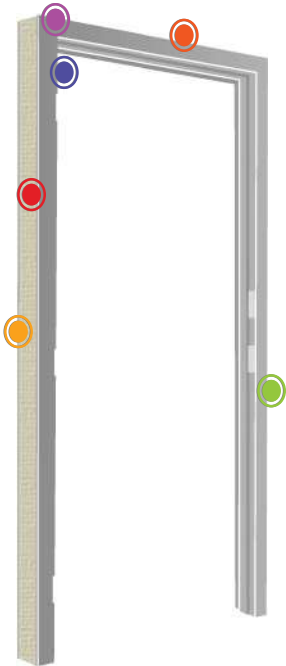

### FEATURES

- Face weld
- 16-gauge A60 galvanized steel standard
- 7-gauge hinge reinforcements standard
- 12-gauge closer reinforcements standard
- Rust-inhibitive prime coat ANSI/SDI 250.10
- Any manufacturer's hinge locations
- Any manufacturer's strike prep location
- Anchors to meet any wall construction
- Stainless steel lock reinforcements per SDI 250.8 Table 4
- Any width and height
- Any jamb depth
- Must be grout filled (by others)
- STC doors available

### MATERIAL OPTIONS

- 14-gauge and 12-gauge steel
- Available in Stainless Steel

### FEATURE OPTIONS

- Continuous weld
- Up to 90 minute fire label

### HARDWARE REINFORCEMENTS

- Optional prep to accept all manufacturers' hardware requirements

### STC Transmission Class Capabilities

STC Range	Description
STC 50 - STC 54	Very loud sounds are faintly heard
STC 40 - STC 49	Loud speech is barely audible
STC 35 - STC 39	Loud speech is audible but words hard to distinguish
STC 30 - STC 34	Loud speech can be distinguished; normal speech barely heard or inaudible



## WINDOW FRAMES

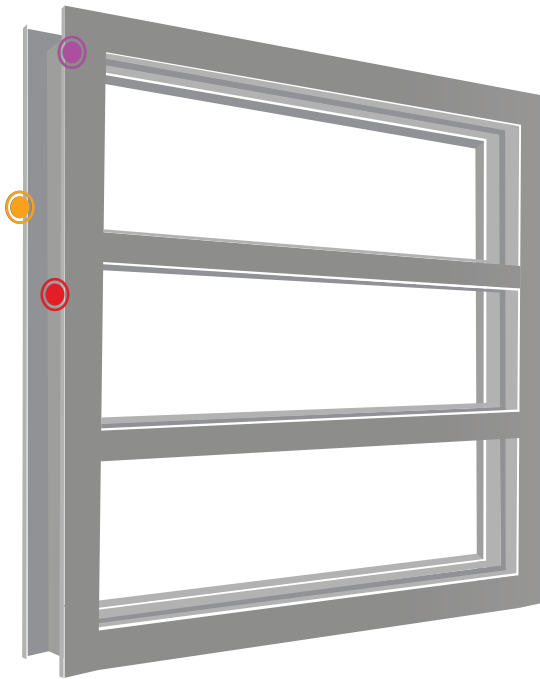

### FEATURES

- Face weld
- 16-gauge A60 galvanized steel standard
- Rust-inhibitive prime coat ANSI/SDI 250.10
- Anchors to meet any wall construction
- Any width and height
- Any jamb depth
- Available in KD Drywall or Masonry
- Glass stop  $\frac{5}{8}$ " width standard. Custom sizes available
- Glazing not included

### MATERIAL OPTIONS

- 14-gauge and 12-gauge steel
- Available in Stainless Steel

### FEATURE OPTIONS

- Up to 90 minute fire label
- Continuous weld
- TIG weld
- Up to STC 53; fire rated up to STC 37



StockPlus™ is Door Components' extraordinary stock door and frame program. Every stock product is made to your requirements.

- **Speed** – We offer the fastest product delivery in the market, with turnaround in as little as one day.
- **Top Quality** – The same materials and quality as our custom products, but with visible seamed edge. All products are galvanized on all surfaces and constructed at the Door Components factory.
- **Flexible Features** – The broadest feature set for custom doors in the market, including support for all manufacturers' hinge and lock locations and many more custom capabilities.
- **Competitive Pricing** – Great prices and no minimum order quantity. Save money by reducing your inventory and ordering from StockPlus.



## Stock Honeycomb and Polystyrene Core Doors

The Door Components stock door program features same day availability. All manufacturers' custom hinge and lock locations are supported.



### Features

- Honeycomb and Polystyrene core is an option in stock doors
- Any manufacturer's hinge locations
- Visible seamed edge
- Next day delivery to five Southern California counties – LA, Orange, Riverside, San Bernardino, San Diego
- Widths 2-6, 2-8, 3-0, 3-6, 4-0
- Heights 6-8, 7-0 and 8-0
- 1 3/4" only
- Prep for 3 each 4 1/2" x .134 mortise hinges
- Interior or exterior usage
- 18 gauge galvanized baked-on prime finish
- 18 gauge top and bottom inverted channels

### Feature Options

- Up to 3 hour fire label
- Flush top cap
- Any manufacturer's Deadlock prep, Panic prep, and Mortise sectional trim
- Flat bar astragal (pairs)

### Hardware Reinforcements

- 3/8" for hinges
- 12-gauge for locks – standard
- 14-gauge for closers – standard
- .180 heavyweight hinges allowed by field modification

866.989.3667 7980 Redwood Ave, Fontana CA 92336 www.doorcomponents.com



## Stock KD Drywall and Masonry Frames with Anchors

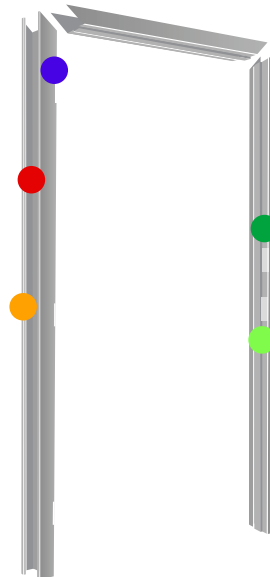

### Features

- Next day delivery in Los Angeles, Orange, Riverside, San Bernardino and San Diego counties of Southern California
- 2" face / equal rabbet
- 1/2" drywall returns
- 16-gauge galvanized baked-on prime finish
- 12-gauge for closers standard
- Rust-inhibitive prime coat ANSI/SDI 250.10
- Any manufacturer's hinge locations
- Prep for three 4 1/2" x .134 mortise hinges (field modification allows for .180 heavyweight hinges)
- ASA Strike prep (4 7/8") or rim panic reinforcement
- Drywall compression anchor standard
- Heights of 6-8, 7-0, and 8-0
- Widths of 2-6, 2-8, 3-0, 3-6, 4-0, 5-0, and 6-0

### Feature Options

- Up to 90 minute fire label
- Deadlock strike

866.989.3667 7980 Redwood Ave, Fontana CA 92336 www.doorcomponents.com

Door Components appreciates the relationship we have with our dealers. Our goal is to lead the industry in providing clear, up-to-date information that helps you support your customers. Consult the Library section of the Door Components website for the latest in cutsheets, product feature sheets, forms, and more.

## SAMPLE PRODUCT SHEETS (available in color, and in b/w for faxing)

**DOOR COMPONENTS**  
Knowledge, Quality & Service

### Custom Honeycomb Core Doors

**Features**

- 1 1/2" standard, also available in 1.3/8"
- Any manufacturer's hinge locations
- 18-gauge A60 galvalneated steel standard
- Continuously welded vertical edges (seamless) standard
- Rust inhibitive prime coat ANSI/SDI 250.10-1998
- Also available as a stock door

**Material Options**

- 16-gauge, 14-gauge and 12-gauge steel
- G90 galvanized steel
- Stainless steel
- Resin impregnated honeycomb

**Feature Options**

- Up to 3 hour fire label
- Integral fire option (1)
- Integral louver option (1)
- Flush top cap (1)
- Any manufacturer's Deadlock prep (1,2), Panic prep (1), and
- Alternative sectional trim (1,2)
- Flat bar astragal (pairs) (1)

**Hardware Reinforcements**

- 3/16" for hinges
- 1/2-gauge for locks standard
- 1/4-gauge for closers standard
- Heavier gauge reinforcements available

(1) Optional feature for an additional charge  
(2) Some trim options are not available in the stock program

866.989.3667 7980 Redwood Ave, Fontana CA 92336 www.doorcomponents.com

## SAMPLE CUT SHEETS

**DOOR COMPONENTS**  
Knowledge, Quality & Service

**DOOR DATA**

MARK NUMBER	SPRNG	DOOR OR PARTIAL DOOR	HEIGHT	THICK	GAUGE	CLOSER	LOCK	QUOTES

**FRAME DATA:**

DOOR	SPRNG	HEIGHT	WIDTH	LOCK	QUOTES

**SALES ORDER AND FIELD MEASUREMENT**

COMPANY NAME: \_\_\_\_\_ PO NUMBER: \_\_\_\_\_  
CUSTOMER: \_\_\_\_\_ JOB NAME: \_\_\_\_\_  
D55

## SAMPLES FROM TECHNICAL DATA MANUAL

**DOOR COMPONENTS**  
Knowledge, Quality & Service

### ADJUSTABLE BASE ANCHOR

MATERIAL: GALVALNEAL  
GAUGE: 16  
TWO SPOT WELDS PER END  
WHI AND UL APPROVED

ANCHOR BOLTS USED FOR FLOOR CONNECTION ARE NOT INCLUDED

ADJUSTABLE ANGLE

11/22/11 www.doorcomponents.com

---

**DOOR COMPONENTS**  
Knowledge, Quality & Service

### LARGE-FACE-HEAD WELDED DOOR

CONTINUOUS WELD RETURN AND FACE GRIND AND FINISH SMOOTH

SLOT

HEAD

NOTCH HEAD FOR RETURN

TAB

MITER

NOTCH JAMB FOR STOP

JAMB

11/22/11 www.doorcomponents.com

---

**DOOR COMPONENTS**  
Knowledge, Quality & Service

### CUSTOM FRAME PROFILES

F1 F2 F3

F5 F6 F7

F9 F10 F11

F13 F14 F15

FRAME PROFILES SHOWN MAY HAVE ANY BACKEND STYLE OR COMBINATION OF BACKEND STYLES

42 www.doorcomponents.com

---

**DOOR COMPONENTS**  
Knowledge, Quality & Service

### FIRE-RATED DOOR TYPES

DOOR TYPES	RATINGS	MAXIMUM FINISH SIZES
SINGLES	2008/30/3001	4-0x10-01 4-0x8-01 5-0x12-01 4-0x8-01 4-0x9-01 5-0x12-01
SINGLES	1800	4-0x10-01 3-0x7-01 4-0x10-01 4-0x8-01
PAIRS	2008/30/3001	8-0x10-01 6-0x8-01 10-0x12-01 8-0x8-01 8-0x9-01 10-0x12-01
PAIRS	1800	8-0x10-01
DOUBLES (EGRESS)	2008/30/3001	8-0x10-01 8-0x8-01
SINGLES (LOUVER)	3008/3001	4-0x10-01 4-0x8-01 5-0x12-01
PAIRS (LOUVER)	4008/3001	8-0x10-01 6-0x8-01 10-0x12-01
SINGLES w/ FILTER	2008/30/3001	4-0x10-01 4-0x8-01 5-0x12-01 4-0x8-01 4-0x9-01 5-0x12-01
PAIRS w/ FILTER	2008/30/3001	8-0x10-01 6-0x8-01 10-0x12-01 8-0x8-01 8-0x9-01 10-0x12-01
OUTSIDE DOOR	2008/30/3001	4-0x10-01 4-0x8-01
STC-363	2008/30/3001	4-0x10-01
STC-375	2008/30/3001	4-0x10-01
STC-403	2008/30/3001	4-0x8-01

100 www.doorcomponents.com 11/22/11

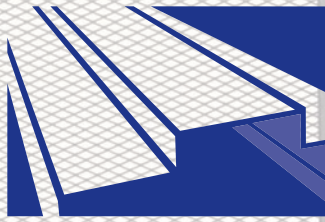

# **DOOR**

**COMPONENTS**<sub>INC</sub>



**Standards As Tough As Steel.™**

**Door Components Inc.**  
**7980 Redwood Ave.**  
**Fontana, CA 92336**

**Toll Free 866.989.9667**  
**Local Phone 909.770.5700**  
**Fax 909.770.5722**

**[sales@doorcomponents.com](mailto:sales@doorcomponents.com)**



**[doorcomponents.com](http://doorcomponents.com)**

